

PauseM®

PauseM® represents the paradigm shift in insect protein production. By pausing the growth of BSF neonate larvae for 21 days after hatching, our breakthrough technology delivers ready-to-use larvae stock ready to be activated precisely when you need them by simply placing them on the feed trays. PauseM® enables high consistency and reproducibility between trays, leading to a more predictable and efficient feed consumption.

The PauseM® Advantage



Ready-to-use

50,000 or 500,000 suspended BSF neonate units are available. Dosage is tailored to meet our customer's facility and yield requirements.



Homogeneous

All neonates are completely synchronized in terms of growth rate and growth phase.



Accurate Counting

Reduced operational challenges in the rearing stage as a result of customized, precise neonates quantity in every PauseM® unit.



Generalist Larvae

Performs effectively in a variety of feed mixes, allowing for the utilization of different waste streams.



High Survival Rate

More than 90% survival rate from neonate to larva phase post-shipment.



Extended Shelf Life

Up to 21 days from hatching, enabling accurate stock management and demand-driven production.



Simple Storage

Stores at room temperature: 18–22°C



Delivered to Your Door

International shipping, produced in Europe.

Quick User Guide

Activation

- Keep in 18–22°C, 60–70% humidity up to 21 days
- Prewarm bottles in rearing room for 30min

WATCH THE
PAUSEM®
RELEASE VIDEO



Tray-to-tray Model

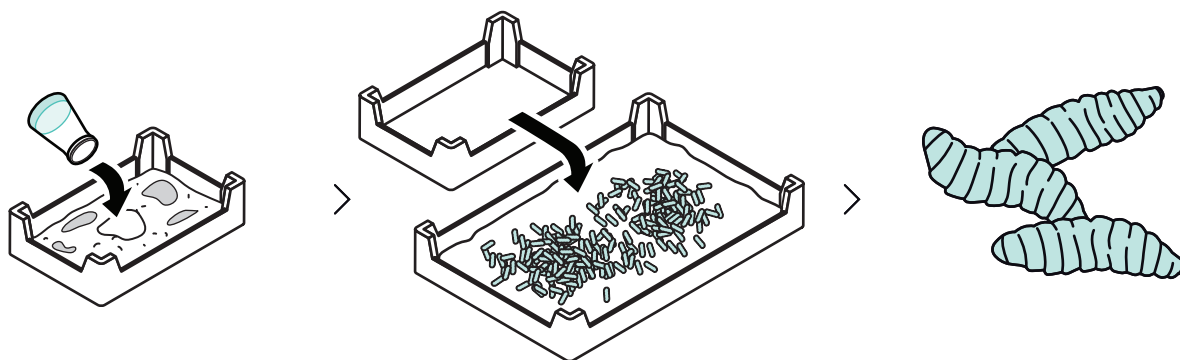

NURSERY

- Grow in 4kg wet feed (preferably 30X35 cm trays)
- Distribute bran at the edges to prevent escape
- Cover with fabric to prevent feed dehydration (optional)

REARING

- Prepare 100X120cm trays with 30kg wet feed
- Transfer the entire content of the nursery tray to the rearing tray

HARVESTING

- Calculate surviving larvae out of seeded
- Measure average larvae weight

Bulk nursery model

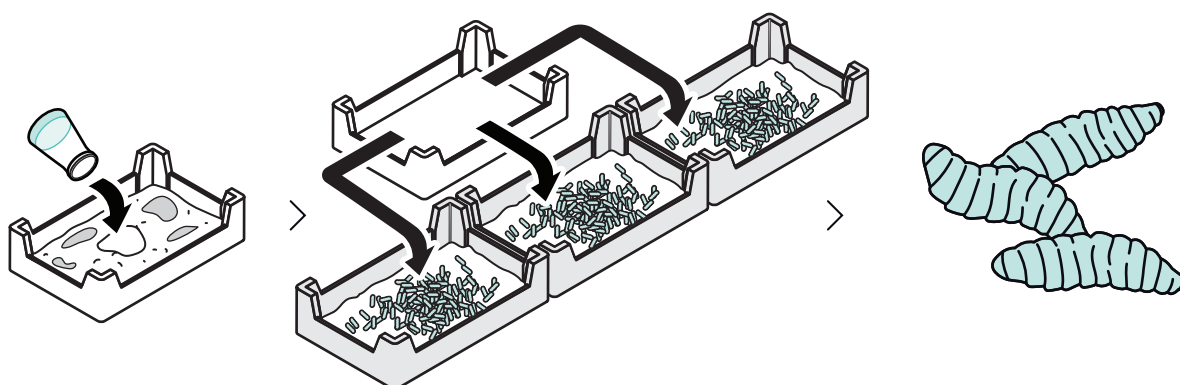

NURSERY

- Grow in 4kg wet feed (preferably 30X35 cm trays)
- Distribute bran at the edges to prevent escape
- Cover with fabric to prevent feed dehydration (optional)

REARING

- Prepare 3 60X40 cm trays with 11kg wet feed
- Divide larvae into the 3 containers by weight (~16,500 larvae in each container)

HARVESTING

- Calculate surviving larvae out of seeded
- Measure average larvae weight

Do's and Dont's

Feed preparation

Use bran on edges of water-free feed or a dry zone in the center of feed containing access water.

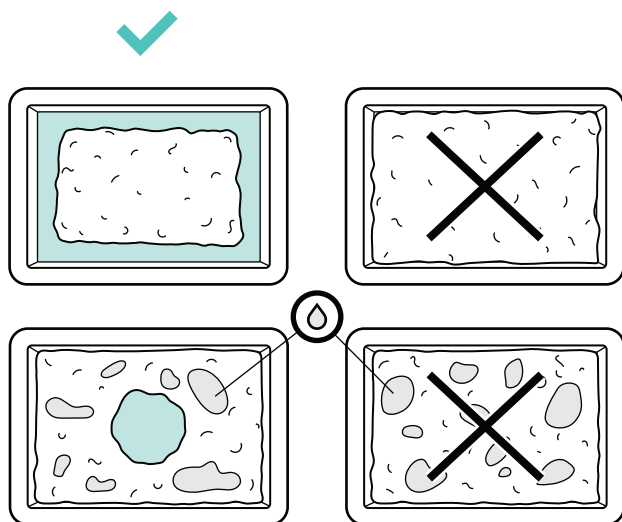

Bottle activation

Release by pushing out the feed. **Do NOT use water.** Make sure you empty the bottle and leave the bottle and plug on the feed without touching the box.

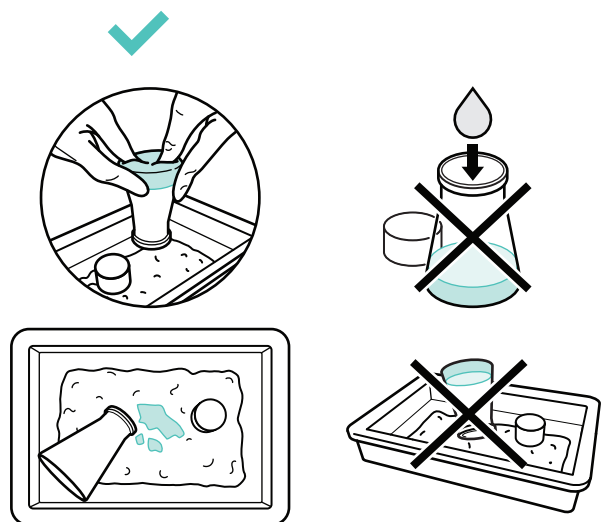

Bottle location when using wet feed and a dry zone

place the bottle and plug in the dry area.

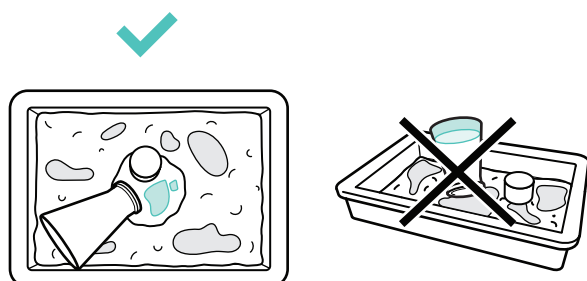

Bottle and feed temperature should be even

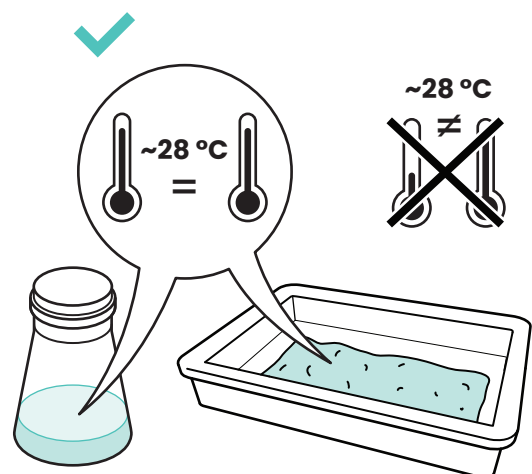



At FreezeM, we're dedicated to making insect breeding accessible, reliable, and sustainable. We understand the unique challenges insect farmers face, especially when it comes to efficient breeding. Our solutions, like PauseM®, are designed with your needs in mind, providing robust, ready-to-use neonates that fit seamlessly into your production cycle. With our innovative approach to breeding and delivery, we aim to support farms worldwide in optimizing operations and contributing to a more sustainable protein future.

If you have any questions, our customer support team is here to help. Please don't hesitate to reach out to us at **support@freezem.com** for guidance or additional information or visit our support center at:

